

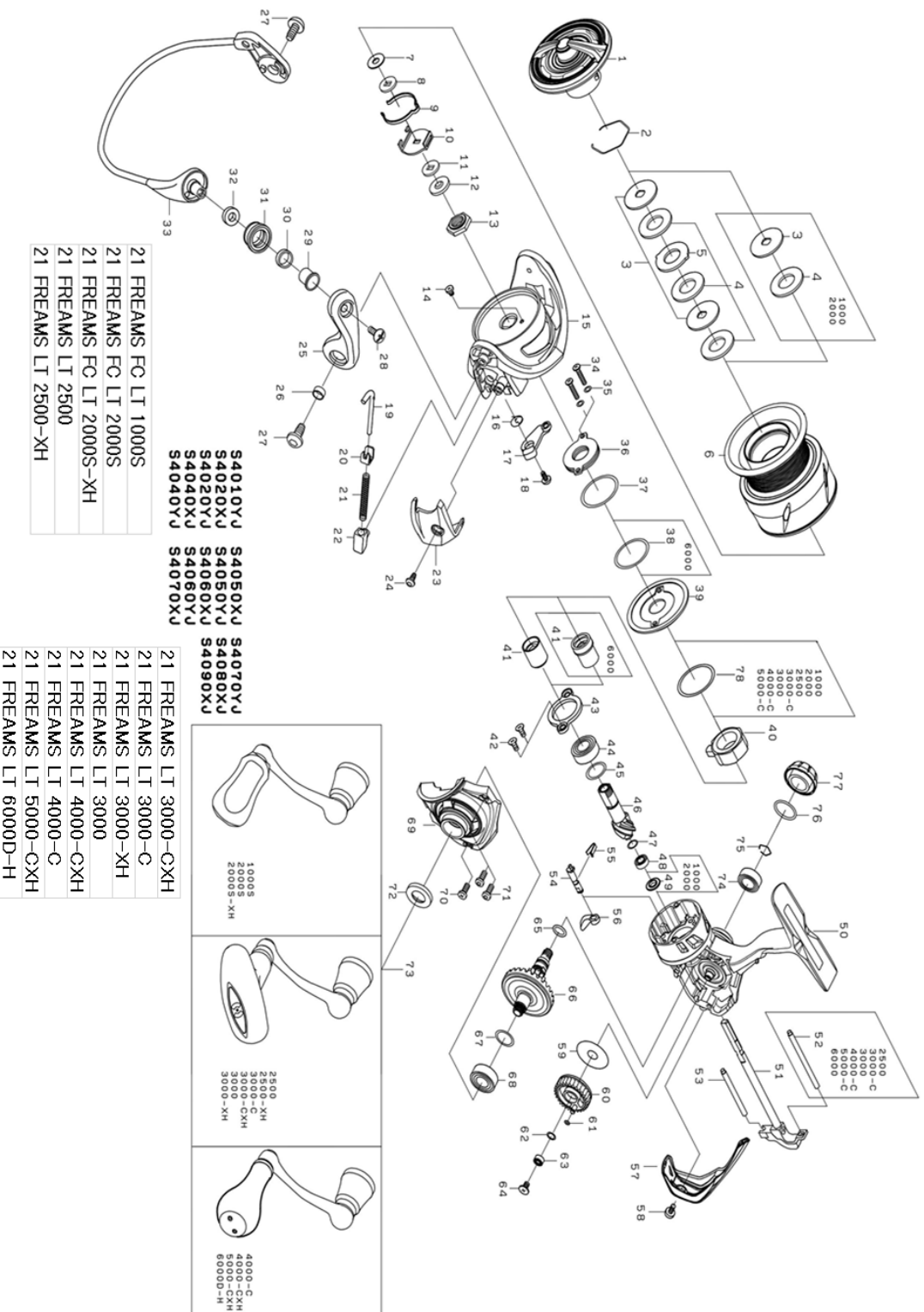

21 FREAMS LT 2500

Feel Alive.

Please quote by part number, not key number when ordering.
 spares@daiwaaustralia.com.au PH: (02) 8644 8644



REEL NAME	MGFT CODE	KEY NO	PARTS CODE	DESCRIPTION
21 FREAMS LT 2500		1	6Q346201	DRAG KNOB
21 FREAMS LT 2500		2	6Q346101	DRAG WASHER RETAINER
21 FREAMS LT 2500		3	6Q621901	KEY WASHER
21 FREAMS LT 2500		4	6J546801	DRAG WASHER
21 FREAMS LT 2500		5	6Q346001	EARED WASHER
21 FREAMS LT 2500		6	6Q709801	SPOOL ASSY (2-6)
21 FREAMS LT 2500		7	6E398003	SPOOL WASHER (A)
21 FREAMS LT 2500		8	6Q348502	SPOOL WASHER (B)
21 FREAMS LT 2500		9	6H416101	CLICK LEAF SPRING
21 FREAMS LT 2500		10	6M021401	CLICK SPRING HOLDER
21 FREAMS LT 2500		11	6Q344001	SPOOL WASHER (C)
21 FREAMS LT 2500		12	6H986901	ROTOR NUT PACKING
21 FREAMS LT 2500		13	6Q177001	ROTOR NUT
21 FREAMS LT 2500		14	6H022701	ROTOR NUT SCREW
21 FREAMS LT 2500		15	6Q343025	ROTOR
21 FREAMS LT 2500		16	6H413601	BAIL TRIP LEVER SPRING
21 FREAMS LT 2500		17	6Q343101	BAIL TRIP LEVER
21 FREAMS LT 2500		18	6H417701	BAIL TRIP LEVER SCREW
21 FREAMS LT 2500		19	6Q343301	ARM LEVER SHAFT
21 FREAMS LT 2500		20	6H576101	ARM LEVER SHAFT PLATE
21 FREAMS LT 2500		21	6J642801	ARM LEVER SPRING
21 FREAMS LT 2500		22	6Q121501	ARM LEVER SPRING HOLDER
21 FREAMS LT 2500		23	6Q343501	ARM LEVER COVER
21 FREAMS LT 2500		24	6Q342901	ARM LEVER COVER SCREW
21 FREAMS LT 2500		25	6Q121623	ARM LEVER
21 FREAMS LT 2500		26	6Q121701	ARM LEVER SCREW COLLAR
21 FREAMS LT 2500		27	6Q343401	ARM LEVER SCREW
21 FREAMS LT 2500		28	6G195602	ROLLER SCREW
21 FREAMS LT 2500		29	6G195501	ROLLER COLLAR (A)
21 FREAMS LT 2500		30	6G220701	ROLLER COLLAR (B)
21 FREAMS LT 2500		31	6J089902	LINE ROLLER
21 FREAMS LT 2500		32	6Q203401	ROLLER COLLAR (C)
21 FREAMS LT 2500		33	6Q777001	BAIL
21 FREAMS LT 2500		34	6G837101	MAGSEALED PLATE SCREW
21 FREAMS LT 2500		35	63754102	MAGSEALED PLATE SCREW WASHER
21 FREAMS LT 2500		36	6J688201	MAGSEALED PLATE
21 FREAMS LT 2500		37	6J354801	MAGSEALED O RING
21 FREAMS LT 2500		38	---	---
21 FREAMS LT 2500		39	6Q266601	MAGSEALED CAP
21 FREAMS LT 2500		40	6J388401	ONEWAY CLUTCH
21 FREAMS LT 2500		41	6J001403	CLUTCH RING
21 FREAMS LT 2500		42	6Q126201	PINION BEARING PLATE SCREW
21 FREAMS LT 2500		43	6Q195601	PINION BEARING PLATE
21 FREAMS LT 2500		44	6G467302	PINION BALL BEARING (A)
21 FREAMS LT 2500		45	63758502	PINION BEARING WASHER
21 FREAMS LT 2500		46	6Q341701	PINION GEAR
21 FREAMS LT 2500		47	6H931701	PINION SPRING WASHER
21 FREAMS LT 2500		48	6H959601	PINION BALL BEARING (B)
21 FREAMS LT 2500		49	---	---
21 FREAMS LT 2500		50	6Q709601	BODY
21 FREAMS LT 2500		51	6Q341501	MAIN SHAFT
21 FREAMS LT 2500		52	6Q126301	OSCILLATING POST (A)
21 FREAMS LT 2500		53	6Q119101	OSCILLATING POST (B)
21 FREAMS LT 2500		54	6Q118101	ANTI REVERSE CAM

